

What will we be learning?

We already know that Skegness is a **town** in the **county** of Lincolnshire. We will use **population** and **land use** maps to learn about our local area. We will also use an Ordnance survey map of our school area to understand a **key** and compare land use within that. We will create our own sketch maps of our local area. We will learn the vocabulary below:

BPA Y4 Geography Knowledge Organiser – Settlements, Local Land Use and Map Skills

We will also be using 8 points on a compass:

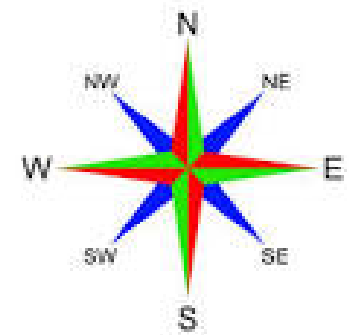
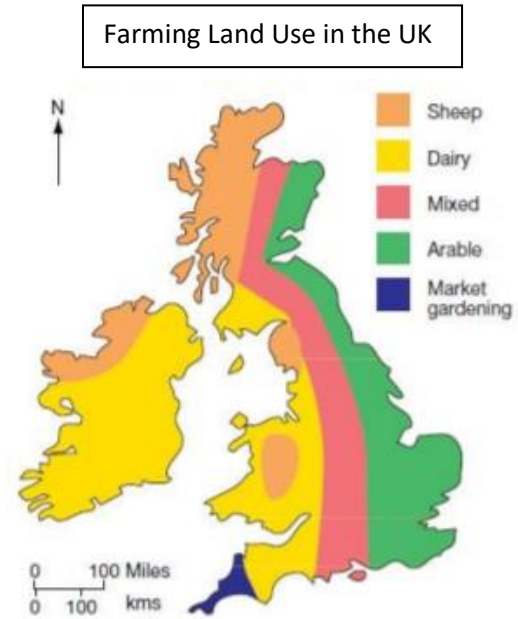
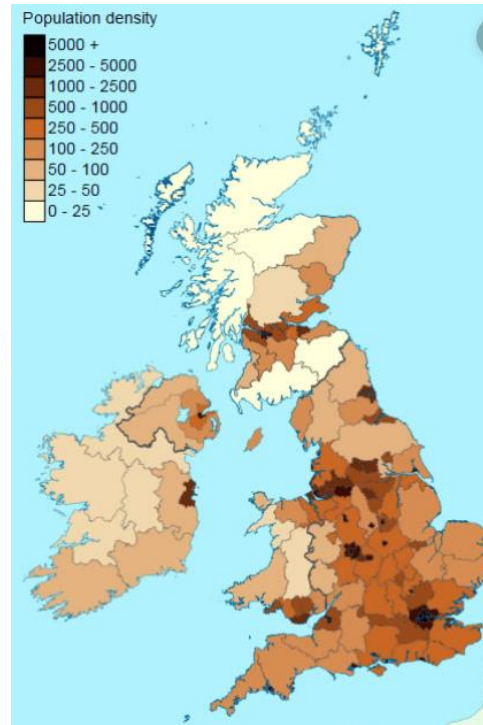

Vocabulary	
agriculture	farming and the methods that are used to raise and look after crops and animals
arable	farming that involves growing crops such as wheat and barley rather than keeping animals or growing fruit and vegetables.
cartographer	somebody who draws and produces maps
city	a large town . London is a city .
coastal	an area of land close to the sea
compass points	any of the main points of a compass: north, south, east, west, north-east, north-west, south-east, south-west
country	an area of land that is controlled by its own government.
county	a region of Britain or Ireland which has its own local government
crop	plants such as wheat and potatoes that are grown in large quantities for food
density	the extent to which something is filled or covered with people or things
farming	the activity of growing crops or keeping animals on a farm
historical	people, situations, or things that existed in the past
human geography	features of land that have been impacted by human activity
key	The key on a map or diagram is a list of the symbols used and their meanings
landscape	everything you can see when you look across an area of land, including hills, rivers, buildings, trees, and plants.
livestock	animals such as cattle and sheep which are kept on a farm
physical geography	natural features of land
present	things and people that exist now
population	all the people who live in a country or area
rural	places that are far away from large towns or cities
urban	belonging to, or relating to, a town or city

4 figure grid references:
 1 = 18 45
 2 = 19 45
 3 = 18 44
 4 = 19 44

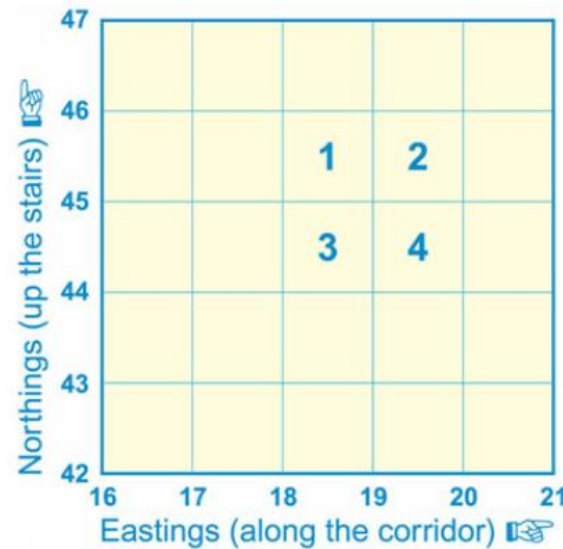

Six-figure grid references

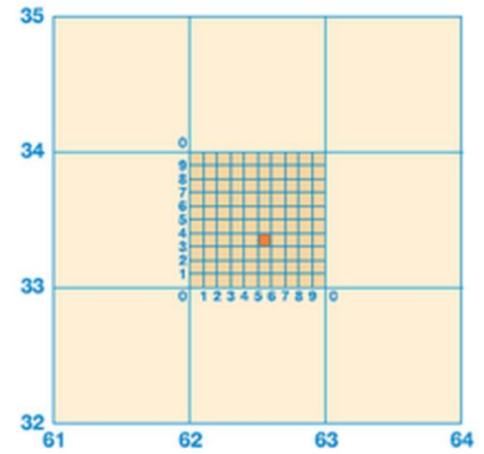

Extra challenge:
 This point is at 625 333

Ideas for home learning:

Learn the vocabulary and definitions.

Make a poster of these words.

Create a word search or cross word using these words.

Find different places that you know on the maps and compare the populations and land uses.

Find other maps of the UK to label the towns and cities of your choice.

Draw a sketch map of your house and garden, your journey to school or any area that you can visit.

Draw a compass and label the compass points.

Practise using the compass directions using a real compass or a compass app.

Look on maps to find grid references. Can you work out 4 figure (and maybe 6 figure) grid references for different places?

Bring any ideas in to show everyone in the class!